



SEAOSD 2015

EXCELLENCE IN STRUCTURAL ENGINEERING AWARDS

The Structural Engineers Association of San Diego (SEAOSD) congratulates and acknowledges six recipients of the 2015 Excellence in Structural Engineering Awards. Recognition was given for creativity and innovation in design, efficiency in use of materials and labor, suitability of the design to the performance objectives of the project, and addressing any unusual challenges of the project. Project submissions were judged by a panel of three structural engineers: Bo Jaquess of TKJ Structural Engineering, Carl Josephson Josephson-Werdowatz & Assoc., Inc., and Franabel Alex-Floresca of NAVFAC Southwest.

Special-Use Structures: Certificate of Merit

Carlsbad Desalination Plant

Owner/Client: Poseidon Water

Project Consultant: ARCADIS U.S., Inc.

Structural Engineer: Kleinfelder | Simon Wong

Contractor: Kiewit Shea Desalination

Used creative solutions for challenging site problems.

- Judges



Special-Use Structures: Certificate of Merit

Central Energy Plant – Grossmont Healthcare District

Owner/Client: Sharp Grossmont Healthcare District

Architect: Hammel, Green & Abrahamson, Inc.

Structural Engineer: Kleinfelder | Simon Wong

Contractor: McCarthy Building Companies

Creatively addressed the myriad of mechanical equipment challenges while navigating a strict OSHPD environment.

- Judges



Retrofit/Alteration: Certificate of Merit

3-Story Office Building Foundation Mitigation

Owner/Client: Confidential

Architect: N/A

Structural Engineer: Degenkolb

Contractor: Soil Engineering Construction

Thorough, clear, thoughtful design solution, very good presentation.

- Judges





New Construction: Award of Excellence

Qualcomm – Pacific Campus Center Building AY

Owner/Client: Qualcomm, Inc.

Architect BNIM

Structural Engineer: Hope-Amundson

Contractor: DPR Construction

A great expression of structural system as architecture. A beautiful marriage of aesthetics, structure and sustainability.

- Judges



New Construction: Certificate of Merit

Mesa College Student Services Building

Owner/Client: San Diego Community College District

Architect: Architects Hanna Gabriel Wells

Structural Engineer: KPF Consulting Engineers

Contractor: PCL Construction Services

Creative Solutions for complex building.

- Judges

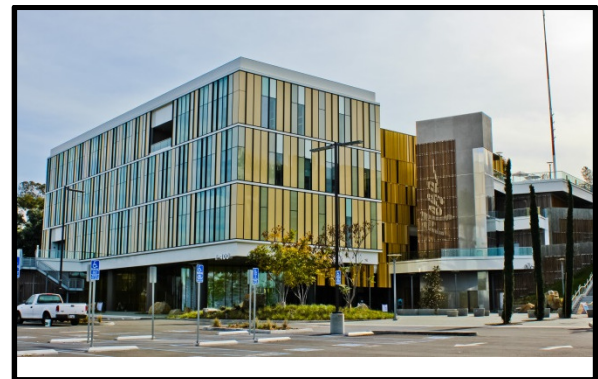

Sustainable Design: Award of Excellence

Stonehaven

Owner/Client: Gregg Hamann

Architect: Paul Giese

Structural Engineer: Patterson Engineers

Contractor: Hamann Construction

Impressive use and incorporation of recycled, native and salvaged materials into the structure.

- Judges

